

Northern Metropolitan Cricket Association Incorporated

(Inaugurated 1922)

A.I.N: A0002386W

A.B.N: 41 787 143 214

NMCA Phone: 0448 513 689

Email: nmca.generalmanager@gmail.com

Web: <https://northmetrocricket.com.au/>



Women's Playing By-Laws

2024-2025

SECTION 5 – WOMEN’S PLAYING BY-LAWS

INDEX

Policies

| | Clause | Page |
|--|--------|------|
| Blood Rule | | 2 |
| Code of Conduct - Victorian Metropolitan Cricket Union INC | | 3 |
| Harassment and Discrimination Policy – NMCA | | 4 |
| Spirit of Cricket | | 5 |
| Sun Smart Policy – VICHEALTH | | 6 |

Senior Playing By-Laws

| | | |
|---|------|----|
| Balls | 5.1 | 7 |
| Cricket Attire | 5.2 | 7 |
| Disputes/Protests Arising From A Match | 5.3 | 8 |
| Grounds/Pitches | 5.4 | 8 |
| Match Points | 5.5 | 8 |
| Match Results | 5.6 | 9 |
| No Ball Call | 5.7 | 9 |
| Scheduled Match Times | 5.8 | 9 |
| Scorebooks / Scorers | 5.9 | 9 |
| Suspensions, Citings and Reports | 5.10 | 9 |
| Team Sheets | 5.11 | 10 |
| Walkovers | 5.12 | 10 |
| Weather Conditions | 5.13 | 11 |
| Women’s Competition – 20/20 Competition | 5.14 | 12 |
| Women’s Competition – One Day 30 Over Competition | 5.15 | 13 |
| Women’s Competition – 10/10 Competition | 5.16 | 14 |
| Women’s Competition – Final Series Qualification Requirements | 5.17 | 15 |
| Women’s Competition – Final Series Formats | 5.18 | 15 |
| Women’s Competition – Marquee Player | 5.19 | 16 |
| Women’s Competition – Inter-Competition Transfer Rule | 5.20 | 16 |
| Women’s Competition – Dual Competition Participation | 5.30 | 17 |

Appendices

| | | |
|-----------------------------|--|----|
| Appendix A: Grounds | | 18 |
| Appendix B: Crease Markings | | 19 |

SECTION 5 – WOMEN’S PLAYING BY-LAWS

BLOOD RULE

- (a) Each team shall have in their possession a properly stocked first aid kit.
- (b) Where a player during the course of a game, suffers any injury which causes bleeding, then the umpire - or in their absence - the captain or team manager, must retire the player from the game until such time as First Aid has been administered to prevent further bleeding.
- (c) The player cannot resume playing until the bleeding has stopped or the wound has been securely covered.
- (d) Any clothing stained with blood must be replaced with clean regulation clothing before the player can resume.
- (e) A batter who is injured and has temporarily retired as above and who is unable to return after the fall of the ninth wicket, shall be deemed to be "Retired Hurt" and the innings of the batting side shall be deemed closed.
- (f) A maximum of 10 minutes shall be allowed for the batter to receive First Aid and resume playing.
- (g) Where an injury occurs to a batter involved in the tenth wicket partnership a maximum of 10 minutes shall be allowed in order for the batter to receive First Aid and resume playing. If the batter is unable to continue within the 10 minutes then she shall be deemed "Retired Hurt" and the innings shall be closed.

Where the injury occurs within 10 minutes of the scheduled tea break, tea shall be taken immediately with no extra time being added. If the batter is unable to continue after the tea interval she shall be deemed "Retired Hurt".

- (h) There shall be no reduction in the number of overs to be bowled when time is lost due to blood rule.
- (i) Where an umpire is injured, sub-clauses (b), (c) and (d) shall apply. If the umpire cannot resume their duties the batting side shall supply an umpire until such time as the umpire is able to resume.
- (j) Clubs are required to have clearly displayed in their clubrooms emergency phone numbers for ambulance; doctor/clinic; nearest hospital.

CODE OF CONDUCT - VICTORIAN METROPOLITAN CRICKET UNION INC.

- (a)** All matches shall be conducted in the true spirit of the game of cricket and club officials, team managers, coaches, captains and players are required to adopt this policy.
- (b)** No player shall, during the match, whether on or off the field of play, engage in conduct unbecoming to the game of cricket.
- (c)** Players are required to respect the Umpire. Players are not permitted to verbally or physically abuse any Umpire, dispute the Umpires decision, or react in a threatening or disapproving manner when given out. Player are required to move immediately from the field and not indulge in tantrums, generally assist the Umpire in carrying out their duties, not indulge in "sledging" opposition players, not verbally or physically abuse opposition players or officials.
- (d)** Clubs shall place all teams (open and under age) under the control of a responsible person.
- (e)** Captains are required to:
 - Instruct players to avoid wasting time - incoming and outgoing batters should pass inside the boundary line and fielders should move quickly to position; and
 - Brief players on the behaviour requirements and request that their players conduct themselves in a manner that conforms to the traditional image of the game of cricket.
- (f)** No alcohol shall be consumed by any players, on or off the ground during any match.
- (g)** Players shall maintain a standard of dress consistent with that required by Association Rules.
- (h)** No player, official or supporter of a member club of the Association shall speak to or at or about any person of any member club of the Association in a manner which abuses, threatens, disparages, vilifies or insults the other person on the basis of that person's race, gender, religion, physical characteristics, colour, decent, national or ethnic origin or any other personal characteristic.
- (i)** Should any breach of this code occur or any action deemed to be detrimental to the game of cricket take place, the matter shall be reported to the Association in accordance with Association Rules and action taken by the Board as deemed necessary.
- (j)** Captains or a Club Official are responsible for seeking the Umpire(s) out at the completion of a day's play to obtain the 'all clear' and/or sign off on reports.

HARASSMENT AND DISCRIMINATION POLICY - NMCA

The Northern Metropolitan Cricket Association is strongly committed to the health, safety and well-being of all its members and participants and is dedicated to providing an environment free of Harassment and Discrimination. Clubs and players are advised to read the **Member Protection Policy** on the VMCU website.

- (a) Harassment is any behaviour by a person or organisation which is offensive, abusive, belittling or threatening and which is directed at a person or group of people because of a particular characteristic of that person or group of people. The behaviour must be unwelcome and the sort of behaviour a reasonable person would recognise as being unwelcome and likely to cause the recipient to feel offended, humiliated or intimidated. Whether or not the behaviour is Harassment is to be determined from the point of view of the person receiving the Harassment.
- (b) **Harassment includes:**
- (i) Sexual Harassment.
 - (ii) Racial Harassment.
 - (iii) Sexuality Harassment.
 - (iv) Disability Harassment.
 - (v) Abuse.
 - (vi) Vilification.
 - (vii) Discrimination.
- (c) **Sexual Harassment includes:**
- (i) An unwelcome sexual advance; or
 - (ii) An unwelcome request for sexual favours; or
 - (iii) Unwelcome conduct of a sexual nature (including a statement, orally or in writing, in person or digitally, of a sexual nature).
- (d) Racial Harassment includes harassment based on colour, descent, national or ethnic origin, cultural activity and sometime religion.
- (e) Disability Harassment includes harassment based on physical, mental or psychological disability or harassment of an associate or aide of a person with a disability.
- (f) Some forms of Abuse may constitute a criminal offence, for example assault and child abuse. If you believe that a criminal offence may have been committed you should seek legal advice and/or notify the police.
- (g) Vilification involves a person inciting hatred towards, serious contempt for, or severe ridicule of, a person or group of persons by public act. Public acts that may amount to vilification include any form of communication to the public and any conduct observable by the public.
- (h) Discrimination is treating or proposing to treat a person less favourably than someone else in certain areas of public life on the basis of an attribute or personal characteristic they have.

PLEASE NOTE:

THIS IS AN EXTRACT OF THE POLICY. CONTACT THE ASSOCIATION TO VIEW THE COMPLETE POLICY

SPIRIT OF CRICKET

The Spirit of Cricket: Cricket is a game that owes much of its unique appeal to the fact that it is expected to be played not only within its Laws, but also within the Spirit of the Game.

Any action, which is seen to abuse this spirit, causes injury to the game itself. The major responsibility for ensuring the spirit of fair play rests with the Captains.

- (a) There are two Laws, which place the responsibility for the team's conduct firmly on the Captain.

Responsibility of Captains:

The Captains are responsible at all times for ensuring that play is conducted within the Spirit of the Game as well as within the Laws.

- (b) **Players' Conduct:**

In the event of any Player failing to comply with the instructions of an Umpire, criticising their decisions by word or action, or showing dissent, or generally behaving in a manner which might bring the game into disrepute, the Umpire concerned shall in the first place report the matter to the other Umpire and to the Player's Captain requesting the latter to take action.

- (c) **Fair and Unfair Play:**

According to the Laws the Umpires are the sole judges of Fair and Unfair Play. The Umpires may intervene at any time and it is the responsibility of the Captain to take action where required.

- (d) **The Umpires are authorised to intervene in cases of:**

- (i) Time Wasting.
- (ii) Damaging the pitch.
- (iii) Intimidatory bowling.
- (iv) Tampering with the Ball.
- (v) Any other action that they feel to be unfair.

- (e) **The Spirit of the Game involves RESPECT for:**

- (i) Your opponents.
- (ii) Your own captain and team.
- (iii) The role of the Umpires.
- (iv) The game's traditional values.

- (f) **It is against the Spirit of the Game:**

- (i) To question an Umpire's decision by word or gesture.
- (ii) To direct abusive language towards an opponent or Umpire.
- (iii) Indulge in cheating or any sharp practice, e.g.
 - i. Appeal, knowing that the Batter is not out,
 - ii. Advance towards an Umpire in an aggressive manner when appealing,
 - iii. Seek to distract an opponent either verbally or by harassment with persistent clapping or unnecessary noise under the guise of enthusiasm and motivation of one's own side.

- (g) **Violence:**

There is no place for any act of violence on the field of play.

- (h) Players, Captains and Umpires together set the tone for the conduct a cricket match and every player is expected to make an important contribution to this.

PLEASE NOTE:

"Spirit of Cricket" means the philosophy developed by the Marylebone Cricket Club and adopted by cricket associations throughout the world which recognizes that the game should be played in accordance with its traditional "spirit" as well as within its laws.

SUN SMART POLICY - VICHEALTH

- (a)** Seek shade between 11 a.m. and 3 p.m. when possible.
- (b)** Play with long sleeve shirt.
- (c)** Wear a cricket club hat in preference to a cap.
- (d)** Clubs must have ample sun screen 30+ accessible to all players.
- (e)** Use Zinc cream to protect sensitive areas - nose, top of ears, lips.
- (f)** Women's Grades are not permitted to play once the temperature exceeds 36C.
- (g)** Where there is inadequate shelter from the sun (e.g. trees, buildings, etc.). Clubs are required to make an effort to provide alternative shade areas.
- (h)** Make adequate provision for extra drink breaks on days over 30C.
- (i)** Ensure that sun screen is re-applied at all available breaks.
- (j)** Wear 'sun smart' colours.
- (k)** Wear appropriate sunglasses where possible.
- (l)** Clubs should provide educational sessions, which shall increase awareness of skin cancer.

These By-Laws are made under the Board's Regulation making power in the Rules and contain various directions and requirements of the Association which are, where the context so indicates, mandatory, but which are not of a general nature which justifies inclusion in the main body of the Rules. These and By-Laws are subject to the Rules.

Definitions and interpretation of these By-Laws shall be in accordance with the Rules.

5.1 BALLS

- 5.1.1 Matches shall commence with two (2) new red 142 gram two-piece Association approved balls, supplied by the Association.
- 5.1.2 Where weather and poor light affect play, teams may choose to play with a new pink 142g two-piece Association approved ball. Both Captains and Umpires must agree, if either party does not agree then the match must proceed using a 142g red ball. This decision must be made prior to the match commencing.
- 5.1.3 The Captains must produce the new ball and an appropriate spare ball at the toss of the coin that meet with the umpire's approval.
- 5.1.4 Clubs not providing or refusing to supply the match ball and spare ball to the umpires as required, shall be penalised as per the Penalties/Fines Schedule.
- 5.1.5 The General Manager, at the completion of the round of matches, is to be notified by a Club, in writing, that the opposing team did not use an association approved ball. The General Manager will then advise the participating clubs on the awarding of the match points.
- 5.1.6 The General Manager is to be advised of all circumstances relating to the non-start of the match and the points and match shall be awarded at the next Operations group meeting.

5.2 CRICKET ATTIRE

- 5.2.1 The playing members of all Clubs must be properly dressed in cricket attire.
- 5.2.2 Cricket attire for players and substitutes shall be defined as:
 - 5.2.2.1 White trousers (shorts, three quarter pants and leggings are not permitted),
 - 5.2.2.2 Association approved two tier Club coloured shirts with sleeves, collar and an approved association Logo, players must wear full length white cricket pants or approved coloured pants. However, all players must wear the same coloured clothing.
 - 5.2.2.3 White sweater, or approved Club coloured sweater,
 - 5.2.2.4 Recognised cricket footwear or runners without spikes,
 - 5.2.2.5 Recognised cricket cap or white hat. (Baseball style caps must be in Club colours and carry club logo).
- 5.2.3 Sweat and headbands are to be skin toned only. White sweaters with club colours on neck, waist or wrist may be worn.
- 5.2.4 Clubs wishing to add another colour to their white shirts (edging/piping on sleeves/collar/panels), must obtain the approval of the General Manager.
- 5.2.5 In the event of any player not conforming to this rule, the player shall be asked to leave the playing field and shall take no further part in the game until their attire meets the standard and shall be fined as per the Penalties/Fines Schedule.
- 5.2.6 Any player persistently refusing to appear in proper cricket attire shall be dealt with as determined by the General Manager.
- 5.2.7 Club logos must be cleared by the General Manager and should appear on the left front of shirt. The NMCA Logo must also appear on the playing shirt in a location approved by the General Manager.
- 5.2.8 Sponsors logos may be placed on either or both shirt sleeves, back of shirts and trouser pockets and shall not exceed the following dimensions:-
 - 5.2.8.1 Shirt Sleeve is to be no more than 10cm long, 5cm high and no lower than 7cm from the top of the sleeve.
 - 5.2.8.2 Back of Shirt is to be no more than 20cm long, 10cm high and no lower than 7cm from where the shirt and collar join.
 - 5.2.8.3 Trouser pockets are to be no more than 10cm long, 10cm high and no lower than 10cm from the top of the trousers.
 - 5.2.8.4 Player Names placed on the back of shirt are to be no more than 10cm high and no lower than 7cm from where the shirt and collar join.
 - 5.2.8.5 Player Numbers placed on the back of the shirt are to be no more than 25cm high, 25cm long and no lower than 10cm from where the shirt and collar join.
- 5.2.9 **Helmets** – In line with Cricket Australia, Cricket Victoria and our direct governing body, the VMCU, the NMCA strongly recommends the wearing of British Standard 7928-2013 compliant helmets when batting. However, wearing of British Standard 7928-2013 compliant helmets will be compulsory when wicket keeping up to the stumps, regardless of the bowling style and when fielding in close to the batter (7 metres from the batter's crease).

5.3 DISPUTES/PROTESTS ARISING FROM A MATCH

- 5.3.1 All Disputes/Protests must be lodged on the nominated results web site within the time frame set out in Women’s Playing By-Law 5.6.1 and notify the Association’s General Manager or Operations Manager who will investigate the dispute. Any such occurrence will be investigated by the General Manager, which will determine a fine and/or loss of points. In the event of loss of points, the opposition team shall be credited with points as determined by the General Manager.
- 5.3.2 The General Manager shall furnish the club against whom the protest is lodged, with a copy.
- 5.3.3 In the event of a match won on dispute/protest, the successful team shall be credited with points as determined by the General Manager.
- 5.3.4 In the event of a dispute/protest in the scores, the Umpire(s) or Club officials, shall impound the scorebooks and forward them to the General Manager on the evening of the days play.
- PLEASE NOTE: Umpires must not indicate to either team their opinion with regards to the result of the match.**
- 5.3.5 Appeals to the General Manager decision must be received by the General Manager, within 48 hours of the decision.
- 5.3.6 The appeal must be in writing, contain new evidence and lodged with the appropriate fee, as per the Penalties/Fines Schedule.
- 5.3.7 This fee shall be refunded if the decision is in favour of the appellant or if such appeal is not considered frivolous.

5.4 GROUNDS/PITCHES

- 5.4.1 All matches shall be played on an association approved wicket covering.
- 5.4.2 Umpires shall be the sole judges of grounds and wickets and shall take control at least 30 minutes prior to the commencement of the match.
- 5.4.3 Grounds and pitches, including the marking of the popping crease with white paint, must be properly prepared for each day's play by the home team, to the satisfaction of the umpire(s). Crease markings (including wide ball guides) are found in Appendix A.
- 5.4.4 Boundary markings:-
- 5.4.4.1 The home team shall provide adequate and appropriate markers to ensure that the boundary does not exceed 50 metres from a line taken from centre stump to the boundary at each end. This will leave a straight boundary to both sides of the wicket from a line of the centre stump at one end to the centre stump at the other end.
- 5.4.4.2 Clubs whose grounds have fixed boundaries must apply Women’s Playing By-Law 5.4.4.1 regardless of the distance of the fixed boundary fence is from the wicket.
- 5.4.5 The home team shall when requested by the umpire, provide sufficient clean sawdust and a broom for the use of bowlers or batters. Umpire(s) must report any breach, and the home team shall be fined as per the Penalties/Fines Schedule. Square leg umpires are not to hold brooms (or any materials) during play.
- 5.4.6 Any Club reported to the General Manager with synthetic covering in such a state of disrepair to be considered dangerous, shall be notified by the General Manager to have that synthetic covering repaired or replaced prior to their next home match.

5.5 MATCH POINTS

5.5.1

| | |
|--|----------------|
| Drawn Match | 3 Points |
| First innings win one-day game, 20/20 game | 6 points. |
| Tie on first innings | 3 points each. |
| Scheduled Bye in Fixture – regardless of other match results | 6 points |

- 5.5.2 In the event of a walkover, points scored shall be the maximum for that round in that grade.
- 5.5.3 In the event of no play taking place in a match due to bad/hot weather or unfit grounds not attributed to either team, the result of such match shall be a draw, and each team shall receive 3 points.
- 5.5.4 In the event of a match won on dispute or protest, the successful team shall be credited with points as determined by the General Manager.
- 5.5.5
- 5.5.5.1 The four competing teams that have obtained the highest number of match points, or where teams have equal match points, the highest percentage, in their grade, at the completion of the home-and-away series of matches shall compete in the semi-final round of matches where this finals structure is fixtured. The winning teams in these matches will proceed to the Grand Final Match.
- 5.5.5.2 The two competing teams that have obtained the highest number of match points, or where teams have equal match points, the highest percentage, in their grade, at the completion of the home-and-away series of matches shall compete directly in the Grand Final matches where this finals structure is fixtured.
- 5.5.5.3 Should two or more competing teams have equal points and percentage at the completion of the home-and-away series, their position on the ladder shall be determined on the result of the home-and-away match between the two clubs during the season. In the event that this does not resolve the situation, the matter shall be decided by the Board.
- 5.5.6 In the event of a tie or draw in the final series, the win shall be awarded to the highest ranked team.
- 5.5.7 Premierships shall be awarded to one club per grade per season.

5.6 MATCH RESULTS

- 5.6.1 Score Service – Home teams must enter the progress results of all matches, on the Association’s nominated results Web Site at the end of each days play. For all Matches played on Saturday or Sunday, no later than 7:00 pm at the end of each days play.
- 5.6.2 Match Results - Both home and away teams are responsible for input on to the Associations nominated results Web Site, their full team as listed on the official team listing and their team’s statistics of the game no later than 9:00 p.m. on the Monday following the completion of the match. For Matches completed on the Monday, then scores must be inputted by 9:00 pm on the Tuesday following the completion of the match. Once the game has been locked by the Operations Manager, it will not be reopened. It is desirable that Club’s enter player statistics as early as possible to assist with the preparation of reports for multi media services.
- 5.6.3 Umpires Report – Must be completed electronically on the Associations nominated results website by each Captain individually by no later than 9:00 p.m. on the Monday following the completion of the match.
- 5.6.4 Any Club not adhering to these Regulations shall incur a penalty/fine as per the Penalties/Fines Schedule.
- 5.6.5 Clubs repeatedly not submitting these reports shall be dealt with by the General Manager.

5.7 NO BALL AND WIDE CALL

- 5.7.1 A ball that lands to the side of the pitch shall be called a “No Ball”.
- 5.7.2 A ball that veers off the pitch and the batter does not have reasonable opportunity to score shall be called a “Wide”.
- 5.7.3 A full toss above the waist of a batter (in her normal batting stance) shall be called a “No Ball” by either umpire.
- 5.7.4 A ball that bounces over the batter’s shoulders (in her normal batting stance) shall be called a “No Ball” by either umpire.
- 5.7.5 A ball that bounces more than twice is a “No Ball”.

Please Note: Deliveries pitching off the pitch are No Balls (not wides), which is important because:

From a **no ball**, batters can be out Hit the Ball Twice, Run Out, Handled the Ball or Obstructing the Field.

From a **wide**, batters can be out Hit Wicket, Stumped, Run Out, Handled the Ball or Obstructing the Field.

5.8 SCHEDULED MATCH TIMES

- 5.8.1 Play shall start and end at the scheduled times, as set out in the By-laws. Failure to complete the scheduled overs within the time allowed shall result in a fine according to the Penalties/Fines Schedule.
- 5.8.2 If play does not start at the scheduled time, due to the lack of material, i.e. stumps, bails, mats, balls or less than 7 players, the offending team shall be fined as per the Penalties/Fines Schedule. The scheduled start time may be amended due to weather conditions.
- 5.8.3 A team, unable to commence the match 15 minutes after the scheduled start time, shall lose the match. The offending team shall pay both teams’ umpires’ fees for that day’s play.
- 5.8.4 For matches fixtured on a Sunday, if the distance via an electronic maps device, between the address of the pavilion of the home team and the address of the pavilion of the away team exceeds 20km, either team may request to commence their match at 10:00am.

The request must be forwarded to the Women’s Manager at nmca.womenscricket@gmail.com at least fourteen (14) days prior to the fixtured date. The game time will be moved if both teams agree, the application has been made within the timeframe and the time movement does not create any fixture or ground clashes. Both teams will be notified of the confirmed game time via email a minimum of seven (7) days prior to the commencement of the match.

5.9 SCOREBOOKS / SCORERS

- 5.9.1 Each Club shall use Association approved scorebooks. All grades must update progressive match scores on the Associations preferred database provider, at the tea break and at the end of each day’s play. If live scoring is undertaken by one team for the duration of a match, the opposition team is required to score exclusively in a scorebook. The home team has preference if both teams are seeking to use live scoring.
- 5.9.2 Scorers in all grades must be sixteen (16) years of age or over.
- 5.9.3 Each Clubs score books shall be signed by the Umpire(s)/Captain(s), if no official umpire(s), at the conclusion of each days play.
- 5.9.5 Home Clubs shall supply and operate a score board which shall be updated at the end of every over by the batting side.

5.10 SUSPENSIONS, CITINGS AND REPORTS

Player Behaviour – Offences and Penalties

Clubs are advised to read the Match Review Panel documentation. This document clearly states the procedures for the reporting of Players or officials. Graded offences, suspension/citing penalties and probation are also contained in this documentation. The document can be found at www.nmca.com.au.

5.11 TEAM LISTINGS/PENALTY TIME/SUBSTITUTIONS

- 5.11.1** Clubs are required to have all team selections posted on the Associations preferred database provider by 9.00PM on the day before the game commences.
- Any Club not adhering to these Regulations shall incur a penalty/fine as per the Penalties/Fines Schedule (Administration Regulation Bylaw 2.17).
- Clubs may make changes to the selected team, but such changes must be completed not later than 30 minutes prior to the scheduled starting time of the game and the team must be updated on the Association preferred database by no later than 7.30PM on the day of the match.
- Registered players as declared on the team listing are the only eligible players to play in the match, and any departure from this means loss of points.
- All players must be 14 years of age or older to participate in the Women's Cricket Competition.
- Any team wishing to play a younger player, must seek permit from the NMCA. Permits will be given upon the discretion of the NMCA Women's Cricket Manager. These permits must be requested and will be approved via the email: nmca.womenscricket@gmail.com
- Only team listings from contested matches will be recognised by the Association. Clubs will not be able to submit team listings for Scheduled Byes, Walkovers, and Completely Abandoned Games (i.e. where no play starts).
- Any team listing at the conclusion of the match, with more than thirteen names shall be investigated by the General Manager, which will determine a fine and/or loss off points. In the event of loss off points, the opposition team shall be awarded the maximum points from the grade in that particular round.
- 5.11.2** Teams are permitted to list up to 13 players on their electronic Team Sheet. Only players who participated in the match can be listed. Only 11 players are permitted to bat in any innings. Only 11 players are permitted to bowl in any innings. The game will count towards finals qualifications for players who either bat/bowl or field and are listed as one of the 13 players on the Team Sheet.
- 5.11.3** Once Clubs have confirmed the match on the Association's nominated results web site, both teams accept the opposition team list is correct. If there are any discrepancies with the opposition's nominated team (missing names, names of players who did not actively play, players playing under fictitious names), Clubs are required to "Dispute" the game on the nominated results web site within the time frame set out in Senior Playing By Laws 3.10.1 and notify the Association's General Manager who will investigate the dispute. Any such occurrence will be investigated by the General Manager, who will determine a fine and/or loss off points. In the event of loss off points, the opposition team shall be awarded the maximum points from the grade in that particular round. There will be no investigation of such incidents if Clubs do not lodge a dispute notice in the required time frame.
- 5.11.3.1** A Player that is absent or leaves the field during play does not serve Penalty Time.
- 5.11.4** Any team may substitute a member of the Armed Services and Emergency Services (MFB, CFA, SES, Victoria Police, and Federal Police) in a match, **but such substitution can only occur after the schedule match has commenced.**
- 5.11.4.1** The substitute player may bat, bowl or keep wickets, or fill any position on the field.
- 5.11.4.2** Proof of "roster change" must be submitted to the General Manager for approval.

5.12 WALKOVERS

The General Manager and Women's Manager shall be notified by the Club giving a walkover (by 9pm Thursday prior to a Saturday game and 9pm Friday prior to a Sunday game).

The General Manager shall also inform the Club receiving the walkover.

5.13 WEATHER CONDITIONS

5.13.1 Adverse Weather:

In the event of active thunderstorm activity in the immediate vicinity of the playing area, all play is to cease **immediately**, and all players, umpires and officials are to find safe shelter without delay.

5.13.2 Extreme Weather:

If, 24 hours prior to the commencement of scheduled play, the forecast temperature by the bureau of meteorology is 36 degrees Celsius or above, or for rain that may make the ground's unplayable, the General Manager, Women's Manager and Senior Sub-Committee shall meet/discuss 24 hours prior to the scheduled days play, or, in extreme, circumstances anytime in the week leading up to the day and make a decision on the merits of playing, amending or abandoning senior women's matches for the day.

The decision to abandon or amend play can be made before the day of play if the General Manager, Women's Manager and Senior Sub-Committee feel that preceding extreme weather or an extreme forecast could put our association members at risk.

Such factors as relative humidity, pollution levels, wind, expected change in weather during the course of the days play and ground conditions shall be taken into account when determining the safety of association players, umpires, scorers, officials and spectators.

Advice may also be sought from third parties in making this decision.

During all Seasons, the General Manager, Women's Manager and Senior Sub-Committee may decide to amend the Start Time of Matches from 9:00am to an earlier time. A decision must be made by 7:30pm on the day prior to scheduled play and shall be conveyed to all clubs by 8:00pm.

During the Summer Season of 30 Over One Day Matches, the General Manager, Women's Manager and Senior Sub-Committee may decide to amend the playing length of the games to 20 Over Matches. A decision must be made by 7:30am and shall be conveyed to all clubs by 8:00am.

A decision must be made by 7:30am on the scheduled day of play, and shall be conveyed to all clubs by 8:00am ONLY if the decision is to abandon the days play. If the decision is to abandon play, this means all matches shall be abandoned.

If there is no abandonment of play and the weather reaches 36 degrees at the Viewbank weather station after the commencement of play, the General Manager shall notify all Clubs that play shall cease immediately for a period of 20 minutes.

If this stoppage is within 20 minutes of the scheduled morning tea break, then the morning tea break shall be taken.

The General Manager, shall monitor the weather and take into consideration of any forecast conditions that could affect the recommencement of play, (cool change, cloud coverage, humidity levels, wind strength and direction etc.).

If, after the 20 minute break and in the General Manager's opinion, the weather conditions are not likely to abate, then he shall contact all Clubs to inform them that play will be abandoned for the remainder of the day.

If, after the 20 minute break and in the General Manager opinion, the weather conditions could change to allow play, then he shall contact all Clubs to inform them that play can recommence.

If play is allowed to recommence, actions which may assist in safe play include;

5.13.2.1 Extra drink breaks (i.e. every 40 minutes and as needed)

5.13.2.2 An extension to the tea break of up to ten (10) minutes, and

5.13.2.3 An extension to the change of innings breaks of up to five (5) minutes.

5.13.2.4 Umpires are advised to extend the scheduled time of completion to allow for these extra breaks.

5.14 WOMEN'S COMPETITION – 20/20 Match

| Scheduled Times: | Start: | Stumps | Overs | No Game | Tea Break |
|------------------|-----------|---------|-------|---------|------------|
| All Grades | 9.00 a.m. | 11:55am | 20/20 | 10 | 10.20 a.m. |

5.14.1 Timing:-

If the innings of the team batting first has not been previously completed, it shall be compulsorily closed at the end of the scheduled overs (20), at which time a 15-minute break shall be taken. It is envisaged along with the umpires (if appointed), that the two (2) competing clubs shall ensure that the over rate is maintained such that the scheduled overs are bowled within the scheduled time. If the overs are not bowled within the prescribed time, clubs shall be fined according to the Penalties/Fines schedule.

5.14.2 Innings interrupted by weather conditions or late start:-

5.14.2.1 If the match commences late or time is lost during the innings of the side batting first the overs shall be reduced from 20 by one (1) over for each seven minutes of lost time.

5.14.2.2 For the team batting first, if the total time lost exceeds 40 minutes and the innings is not previously completed, then it shall be compulsorily closed on completion of 10 overs. If 10 overs have not been bowled to the side batting first (given the innings is not previously completed) by 11.45am then play shall be abandoned. The match is declared a draw.

5.14.2.3 Ten (10) overs is the minimum number of overs to constitute a game (i.e. the “no game” overs).

5.14.2.4 If a 20/20 match has not started by 10.30 am then play will be abandoned. The match is declared a draw.

5.14.3 First Innings Compulsory Closure:-

The side batting second shall be entitled to bat only for the same number of balls bowled to the first side.

5.14.4 First Innings Not Compulsorily Closed:-

The side batting second shall be entitled to bat only twenty (20) overs. However, if lost time reduced the overs entitlement for the side batting first, then the side batting second shall be entitled to bat only for the same reduced number of balls.

5.14.5 Cessation of Play:-

Play shall continue until the side batting second has received entitlement under clauses 5.14.3 and 5.14.4. Play shall cease before this if any of the following apply:

5.14.5.1 Play is abandoned due to bad weather.

5.14.5.2 Play has been delayed or interrupted for more than thirty (30) minutes by bad weather during the innings of the side batting second and the entitled overs have not been bowled by 12.15 pm, then play shall cease at the completion of the over in progress at 12.15 pm.

5.14.5.3 Play shall not resume after any interruption due to bad weather any time after 12.15 pm.

5.14.6 Failure to comply with the finish of play at the scheduled time shall result in penalties, as per Penalties/Fines Schedule.

5.14.7 A fielding team shall have no more than 5 fielders on the leg side and no more than 2 fielders behind the popping crease on the leg side at any time. Any breach of this rule shall result in the call of "No Ball".

5.14.8 No over may be longer than 8 balls, including no balls/wides.

5.14.9 The responsibility of completing the required number of overs on time rests with both teams.

5.14.10 A bowler shall be restricted to a maximum of one fifth (20÷4) of the scheduled overs in an innings.

5.14.11 Crease markings, including wide ball guidelines, for this form of the game are found in Appendix A at the end of the By-laws.

5.14.12 A batter must retire immediately when they have reached 35 runs and may return to the crease when all other players listed on the team sheet have batted. Should more than one player retire, the retired players must return in order of retirement. A batter who retires **voluntarily** before they have reached 35 runs may return to the crease when all other players listed on the team sheet have batted and if other players have retired, must return in order of retirement.

5.14.13 Each team must have a minimum of 8 players before the match can commence. A maximum of 11 fielders may be on the field at any time.

In Heather Baillie Shield, if a team has less than eleven players on the field, then the other team is restricted to use the same number of fielders. If this occurs, players can be substituted at any time and can bowl without any time restrictions. Teams can bat up to 11 batters regardless of opposition team numbers.

5.14.13.1 In Heather Baillie Shield, the opposition team may offer the team with less players “substitute fielders” and if these are taken, both teams play with the number of fielders who take the field for the team who has accepted the substitutes.

If these substitute fielders are not accepted by the team with less than 11 players, the team with 11 players is permitted to field with the full 11.

5.14.13.2 Teams are permitted to list up to 13 players on their Team Sheet. Only 11 players are permitted to bat in any innings. Only 11 players are permitted to bowl in any innings.

5.14.14 In Lorraine Ireland & Lenore Smith Shield, the batting team must supply the square leg umpire. In Heather Baillie Shield, the fielding team must supply the square leg umpire. This allows for assistance in field placements and bowling changes.

5.14.14.1 It is expected that team based Square Leg Umpires adhere to the Spirit of Cricket in their communication and behaviour whilst undertaking their umpiring duties. Any encouragement, advice and/or support given to playing members whilst on the field must be reasonable, brief and succinct. Play must not be delayed or impaired due to Square Leg Umpires coaching or undertaking lengthy conversation and playing instruction.

5.14.15 Overs are to be bowled in 5 over blocks.

5.15 WOMEN'S COMPETITION – One Day Match

| Scheduled Times: | Start: | Stumps | Overs | No Game | Tea Break |
|------------------|-----------|-----------|-------|---------|------------|
| All Grades | 9.00 a.m. | 1.20 p.m. | 30/30 | 15 | 11.00 a.m. |

5.15.1 Timing:-

If the innings of the team batting first has not been previously completed, it shall be compulsorily closed at the end of the scheduled overs (30), at which time a 20-minute break shall be taken. It is envisaged along with the umpires (if appointed), that the two (2) competing clubs shall ensure that the over rate is maintained such that the scheduled overs are bowled within the scheduled time. If the overs are not bowled within the prescribed time, clubs shall be fined according to the Penalties/Fines schedule.

5.15.2 Innings interrupted by weather conditions or late start:-

5.15.2.1 If the match commences late or time is lost during the innings of the side batting first the overs shall be reduced from 30 by one (1) over for each seven minutes of lost time.

5.15.2.2 For the team batting first, if the total time lost exceeds 50 minutes and the innings is not previously completed, then it shall be compulsorily closed on completion of 15 overs. If 15 overs have not been bowled to the side batting first (given the innings is not previously completed) by 11.50 am, then play shall be abandoned. The match is declared a draw.

5.15.2.3 Fifteen (15) overs is the minimum number of overs to constitute a game (i.e. the "no game" overs).

5.15.2.4 If a 30/30 match has not started by 11.00 am then play will be abandoned. The match is declared a draw.

5.15.3 First Innings Compulsory Closure:-

The side batting second shall be entitled to bat only for the same number of balls bowled to the first side.

5.15.4 First Innings Not Compulsorily Closed:-

The side batting second shall be entitled to bat only thirty (30) overs. However, if lost time reduced the overs entitlement for the side batting first, then the side batting second shall be entitled to bat only for the same reduced number of balls.

5.15.5 Cessation of Play:-

Play shall continue until the side batting second has received entitlement under clauses 5.15.3 and 5.15.4. Play shall cease before this if any of the following apply:

5.15.5.1 Play is abandoned due to bad weather.

5.15.5.2 Play has been delayed or interrupted for more than thirty (30) minutes by bad weather during the innings of the side batting second and the entitled overs have not been bowled by 1.30pm, then play shall cease at the completion of the over in progress at 1.30 pm.

5.15.5.3 Play shall not resume after any interruption due to bad weather any time after 1.30 pm.

5.15.6 Failure to comply with the finish of play at the scheduled time shall result in penalties, as per Penalties/Fines Schedule.

5.15.7 A fielding team shall have no more than 5 fielders on the leg side and no more than 2 fielders behind the popping crease on the leg side at any time. Any breach of this rule shall result in the call of "No Ball".

5.15.8 No over may be longer than 8 balls, including no balls/wides.

5.15.9 The responsibility of completing the required number of overs on time rests with both teams.

5.15.10 A bowler shall be restricted to a maximum of one sixth (30÷6) of the scheduled overs in an innings.

5.15.11 Crease markings, including wide ball guidelines, for this form of the game are found in Appendix A at the end of the By-laws.

5.15.12 A batter must retire immediately when they have reached 50 runs and may return to the crease when all other players listed on the team sheet have batted. Should more than one player retire, the retired players must return in order of retirement.

A batter who retires **voluntarily** before they have reached 50 runs may return to the crease when all other players listed on the team sheet have batted and if other players have retired, must return in order of retirement.

5.15.13 Each team must have a minimum of 8 players before the match can commence. A maximum of 11 fielders may be on the field at any time.

In Heather Baillie Shield, if a team has less than eleven players on the field, then the other team is restricted to use the same number of fielders. If this occurs, players can be substituted at any time and can bowl without any time restrictions. Teams can bat up to 11 batters regardless of opposition team numbers.

5.15.13.1 In Heather Baillie Shield, the opposition team may offer the team with less players "substitute fielders" and if these are taken, both teams play with the number of fielders who take the field for the team who has accepted the substitutes.

If these substitute fielders are not accepted by the team with less than 11 players, the team with 11 players is permitted to field with the full 11.

5.15.13.2 Teams are permitted to list up to 13 players on their Team Sheet. Only 11 players are permitted to bat in any innings. Only 11 players are permitted to bowl in any innings.

5.15.14 In Lorraine Ireland & Lenore Smith Shield, the batting team must supply the square leg umpire. In Heather Baillie Shield, the fielding team must supply the square leg umpire.

5.15.14.1 It is expected that team based Square Leg Umpires adhere to the Spirit of Cricket in their communication and behaviour whilst undertaking their umpiring duties. Any encouragement, advice and/or support given to playing members whilst on the field must be reasonable, brief and succinct. Play must not be delayed or impaired due to Square Leg Umpires coaching or undertaking lengthy conversation and playing instruction.

5.15.15 Overs are to be bowled in 5 over blocks.

5.16 WOMEN'S COMPETITION – 10/10 Match

5.16.1 Timing:-

Each team has a maximum of 40 minutes to complete their innings. If the innings of the team batting first has not been previously completed, it shall be compulsorily closed at the end of the scheduled time, at which time a 5-minute break shall be taken. It is envisaged along with the umpires (if appointed), that the two (2) competing clubs shall ensure that the over rate is maintained such that the scheduled overs are bowled within the scheduled time. If the overs are not bowled within the prescribed time, the batting team will be awarded 2 runs per ball for the remaining deliveries that have not been completed within the allocated 40 minute innings timeframe.

5.16.2 Innings interrupted by weather conditions or late start:-

5.16.2.1 If the match commences late or time is lost during the innings of the side batting first the overs shall be reduced from 10 by one (1) over for each seven minutes of lost time.

5.16.2.2 For the team batting first, if the total time lost exceeds 20 minutes and the innings is not previously completed, then it shall be compulsorily closed on completion of 5 overs. If 5 overs have not been bowled to the side batting first (given the innings is not previously completed) by 22 minutes from the scheduled start of play then play shall be abandoned. The match is declared a draw.

5.16.2.3 Five (5) overs is the minimum number of overs to constitute a game (i.e. the "no game" overs).

5.16.2.4 If a 10/10 match has not started within 60 minutes for the scheduled starting time then play will be abandoned. The match is declared a draw.

5.16.3 First Innings Compulsory Closure:-

The side batting second shall be entitled to bat for a minimum of the same number of balls bowled to the first side, and a maximum of 10 overs in 40 minutes.

5.16.4 First Innings Not Compulsorily Closed:-

The side batting second shall be entitled to bat only ten (10) overs. However, if lost time reduced the overs entitlement for the side batting first, then the side batting second shall be entitled to bat only for the same reduced number of balls.

5.16.5 Cessation of Play:-

Play shall continue until the side batting second has received entitlement under clauses 5.16.3 and 5.16.4. Play shall cease before this if any of the following apply:

5.16.5.1 Play is abandoned due to bad weather.

5.16.5.2 Play has been delayed or interrupted for more than thirty (30) minutes by bad weather during the innings of the side batting second and the entitled overs have not been bowled by expiry of 40 minutes from the start of the innings, then play shall cease at the completion of the over in progress at the 40th minute.

5.16.5.3 Play shall not resume after any interruption due to bad weather any time after 40 minutes from the commencement of the innings.

5.16.6 Failure to comply with the finish of play at the scheduled time shall result in the awarding of penalty runs to the opposition team.

5.16.7 A fielding team shall have no more than 5 fielders on the leg side and no more than 2 fielders behind the popping crease on the leg side at any time. Any breach of this rule shall result in the call of "No Ball".

5.16.8 No over may be longer than 6 balls, including no balls/wides.

5.16.8.1 If a no ball or wide is bowled it will be counted as two runs to the batting team. It will be counted within the 6 balls of that over.

5.16.8.2 The responsibility of completing the required number of overs on time rests with both teams.

5.16.9 A bowler shall be restricted to a maximum of one fifth (10=2) of the scheduled overs in an innings.

5.16.10 Crease markings, including wide ball guidelines, for this form of the game are found in Appendix A at the end of the By-laws.

5.16.11 A batter must retire immediately when they have reached 25 runs and may return to the crease when all other players listed on the team sheet have batted. Should more than one player retire, the retired players must return in order of retirement. A batter who retires **voluntarily** before they have reached 25 runs may return to the crease when all other players listed on the team sheet have batted and if other players have retired, must return in order of retirement.

5.16.12 Each team must have a minimum of 8 players before the match can commence. A maximum of 10 fielders may be on the field at any time.

5.16.12.2 Teams are permitted to list up to 13 players on their Team Sheet. Only 11 players are permitted to bat in any innings. Only 11 players are permitted to bowl in any innings.

5.16.13 The fielding team must supply the square leg umpire. This allows for assistance in field placements and bowling changes.

5.16.13.1 It is expected that team based Square Leg Umpires adhere to the Spirit of Cricket in their communication and behaviour whilst undertaking their umpiring duties. Any encouragement, advice and/or support given to playing members whilst on the field must be reasonable, brief and succinct. Play must not be delayed or impaired due to Square Leg Umpires coaching or undertaking lengthy conversation and playing instruction.

5.16.14 Overs are to be bowled in 5 over blocks.

5.16.15 The playing field shall be roped off at 40 metres and games will be played on a standard pitch.

5.17 WOMEN'S COMPETITION – FINAL SERIES QUALIFICATION REQUIREMENTS

5.17.1 Players must have played one third of the Clubs contested home and away matches (inclusive of T10, T20 and One Day Format matches) in the grade in which the finals are being played, during the home and away season to qualify for the semi-final and final matches. Contested games means a game that has commenced by the bowling of one legal delivery. For qualification purposes this means that byes, walkovers received and completely abandoned matches (where no play has commenced) will have adjustments made to the qualification quotient. Affected clubs will be informed by the General Manager as close to the end of the season as possible to assist Clubs with player qualifications. Teams that give walkovers will not have any adjustments to their qualification quotient nor can they submit a team sheet for the match forfeited.

Amended qualification rules exist for players from clubs participating under the Dual Competition Rule as per Rule 5.3.

| Completed Games | Qualification Games |
|------------------------|----------------------------|
| 7 - 9 | 3 |
| 4 - 6 | 2 |
| 1 - 3 | 1 |

5.17.2 Finals System: The format of all finals series will be advised to participating Clubs at the start of each programmed series.

5.17.3 Open selection occurs when a club has two consecutive teams playing in finals. It allows a player qualified in a higher grade to play in the finals series of a lower grade for which she has not qualified under Senior Playing By-Law 5.17.1

5.18 WOMEN'S COMPETITION – FINALS SERIES

5.18.1 All Finals shall be played under the home and away match conditions.

5.18.2 Players must have played a minimum of matches in the Designated Competition and designated grade, to be eligible to play in the Final Series. The number of matches is determined by the table in Women's Players By-Laws Sub-Clause 5.17.1.

5.18.3 Shields shall be awarded after the final for each grade. Shields must be returned to the Women's Manager or General Manager within seven (7) days after the final.

5.18.3.1 Clubs may borrow shields for functions, but must notify the General Manager in writing or electronically.

5.18.3.2 Clubs failing to return the shield within scheduled time shall be fined according to the Penalties/Fines schedule.

5.19 WOMEN'S COMPETITION – MARQUEE PLAYERS

5.19.1 Definition: Premier – inclusive of Premier One and Premier Two

Women's Community Cup Competition (WCCC) – inclusive of Shield, North West A/B, South, East Divisions

Each team will be permitted one of the following options/combinations of the following marquee players:

One Player who has played in Premier One or Two in Victoria or an equivalent state body between 1985 to the present time.

Or

One Player who has played at State or National Representative level for another country between 1985 to the present time.

Or

One Player who has played in WCCC Shield Division and one player who has played no more than fifteen games in the Women's Community Cup Competition North West A/B, South, East or equivalent between 1985 to the present time.

Or

Lorraine Ireland Shield ONLY

Three players who have played three or more games in the Women's Community Cup Competition North West A/B, South, East or equivalent between 1985 to the present time.

Lenore Smith & Heather Baillie ONLY

Two players who have played three or more games in the Women's Community Cup Competition North West A/B, South, East or equivalent between 1985 to the present time.

Players who have participated in less than five games in the Women's Community Cup Competition (WCCC) between 1985 to the present time before joining the NMCA are not deemed marquee players. Players who have participated in Premier, WCCC and state equivalents before 1985 are not deemed marquee players.

Players who have commenced their cricket playing within the NMCA and have participated in less than five games in the Women's Community Cup Competition (WCCC) between 1985 to the present time are not eligible to attract marquee player status. Players who have commenced their cricket playing within the NMCA and whose participation in the Women's Community Cup Competition (WCCC) between 1985 to the present time exceed five games are eligible to attract marquee status at the discretion of the NMCA Women's Manager and NMCA Executive. This will be managed seasonally. Any player who commenced their cricket playing in the NMCA and plays one or more games in Premier One or Premier Two or Shield will be eligible to attract marquee status.

If a player has played three consecutive seasons of junior cricket at an NMCA club prior to playing in Premier or WCCC Shield, North West A/B, South, East they are not eligible to attract marquee status until they reach the age of 21. Until this age, they are permitted to play for their NMCA Junior Club within the NMCA Women's Competition without marquee status.

Clubs are permitted to have one of the marquee options/combinations for each team that participates in the NMCA Women's Cricket Competition.

Players who are nominated Marquee Players are exempt from the Inter-Competition Transfer and Dual Competition Participation Rules.

Players who participate in the Northcote CC Pathway Program are exempt from marquee status and may return to play at their NMCA club at any time. This applies to all participants in the Under 18s Competition and Women's Pathway Program.

5.19.2 The marquee player/s must be nominated nmca.womenscricket@gmail.com prior to the commencement of each season. The marquee player must be approved by the NMCA before they can commence playing.

5.19.3 In a club where more than one team participates in the NMCA Women's Cricket Competition, teams are required to nominate their marquee player/marquee player combination for the season. Marquee players are only permitted to move upwards between the teams from Division Two to Division One, during a season in the instance of absence or injury to the nominated Division One marquee player. The combination of marquee players in any given team must not exceed or go beyond the bounds of the outline above or the game will be deemed a walkover with 6 match points awarded to the opposition team.

5.20 WOMEN'S COMPETITION – INTER-COMPETITION TRANSFER RULE

5.20.1 Any player that has commenced their cricket within the NMCA at a Junior or Senior level and chooses to participate in an external competition within Victoria (Premier, Shield, WCCP) is permitted to return to play in the NMCA Women's Cricket Competition with the following restrictions:

5.20.1.2 Once 6 games are played in an external competition, a player is deemed 'transferred' to that competition for the remainder of the 2024/25 Season, including finals series. The player will not be able to participate in the NMCA for the remainder of the 2024/25 Season.

5.20.1.3 To qualify for NMCA finals, all players must play the required number of games as per the current qualification for each season. However, if they have also played 6 or more games in an external competition, any finals qualifications within the NMCA will become void.

5.20.1.4 Any new player wishing to participate in the NMCA, who has prior cricketing experience and participates with an NMCA club within an external competition and has not previously played in the NMCA will be subject to the marquee player rule.

5.20.1.5 Nominated Marquee Players and Clubs participating under the Dual Competition Participation rule are exempt from the Inter-Competition Transfer Rule.

5.21 WOMEN'S COMPETITION – DUAL COMPETITION PARTICIPATION

NMCA Clubs who have women's teams participating in both the NMCA Women's Competition and a higher external Competition are required to nominate a team of players who will be excluded from participation in the NMCA Women's Competition for the duration of the season (Spring & Summer).

- 5.21.1** The list of excluded players must contain at least eight (8) and up to twelve (12) names of players registered to the Club. This list must be approved by the NMCA Women's Manager and NMCA Executive at least two months prior to the commencement of the NMCA season. Players that do not feature on this excluded list are known as "non-listed players".
- 5.21.2** All non-listed players at the Club may move between the two teams and competitions freely and without attracting Marquee or Transfer Status for the duration of the season (Spring & Summer). They must play two thirds of all NMCA fixtured matches in each season to be eligible to participate in the NMCA finals series.
- 5.21.3** Any games played in the NMCA by non-listed on the same weekend as their participation in a game in a higher competition are not eligible to be counted towards finals qualifications.
- 5.21.4** Nominated Marquee Players are exempt from the Inter-Competition Transfer Rule.

APPENDIX A - NMCA COMPETITION GROUNDS

| LGA | Venue | Address | Club |
|-------------|----------------------------|---|---|
| Booroondara | Macleay Park #2 | Barmoral Road | Balwyn North Bulls Women's |
| Banyule | Warringal Park | Beverley Road, Heidelberg | Heidelberg Women's |
| Banyule | Heidelberg Park | Beverley Road, Heidelberg | Heidelberg Women's |
| Banyule | Beverley Road Oval | Beverley Road, Banyule | Banyule Women's |
| Banyule | Cartledge Reserve | Valentine Road, Ivanhoe West | West Ivanhoe Juniors |
| Banyule | Chelsworth Park Mid East | Irvine Road, East Ivanhoe | Old Ivanhoe Grammarians |
| Banyule | Chelsworth Park South East | Irvine Road, East Ivanhoe | Old Ivanhoe Grammarians |
| Banyule | Ford Park North | Davidson Street, Bellfield | Bellfield |
| Banyule | Greensborough War Memorial | Henry Street, Greensborough | Greensborough Women's |
| Banyule | Montmorency Park South | Para Road, Montmorency | Lower Plenty Women's |
| Banyule | Olympic Park North | Catalina Street, West Heidelberg | Bellfield |
| Banyule | Olympic Park South | Catalina Street, West Heidelberg | UNAVAILABLE |
| Banyule | Seddon Reserve | Sparkford Street, West Ivanhoe | West Ivanhoe Juniors |
| Banyule | Shelley Park | Shelley Street, West Heidelberg | Olympic Colts / Olympic Fillies Women's |
| Banyule | Whatmough Park | Kalparrin Avenue, Greensborough | Riverside Women's |
| Darebin | C.H. Sullivan Park East | Blake Street, Reservoir | Fiji Victorian |
| Darebin | C.H. Sullivan Park West | Blake Street, Reservoir | Fiji Victorian |
| Darebin | C.T. Barling Park East | Plenty Road, Reservoir | Reservoir Cobras / Reservoir Cobras Women's |
| Darebin | C.T. Barling Park North | Plenty Road, Reservoir | West Preston |
| Darebin | H.L.T. Oulton Park North | Bell Street & Albert Street, Preston | Preston Baseballers / Preston Baseballers Women's |
| Darebin | H.L.T. Oulton Park South | Bell Street & Albert Street, Preston | Preston Baseballers |
| Darebin | H.P. Zwar Park | Jessie Street, Preston | West Preston |
| Darebin | Hayes Park East | Flinders Street, Thornbury | Holy Trinity Women's |
| Darebin | I.W. Dole Reserve | Dole St. & Cheddar Rd, Reservoir | Ivanhoe Mavericks |
| Darebin | J.C. Donath Reserve #1 | Harmer Street, Keon Park | Keon Park |
| Darebin | J.C. Donath Reserve #2 | Harmer Street, Keon Park | Keon Park / West Preston |
| Darebin | J.C. Donath Reserve #4 | Harmer Street, Keon Park | Camrea / Camrea Women's |
| Darebin | J.C. Donath Reserve #6 | Harmer Street, Keon Park | Donath |
| Darebin | J.C. Donath Reserve #7 | Harmer Street, Keon Park | Camrea |
| Darebin | J.E. Moore Park North | Gilbert Road, Reservoir | Preston YCW District |
| Darebin | J.E. Moore Park South | Henty Street, Reservoir | Cameron / Cameron Women's |
| Darebin | John Hall Reserve | Dunne Street, Kingsbury | UNAVAILABLE |
| Darebin | T.W. Blake Park #1 | Murray Rd & Gower St, Preston | UNAVAILABLE |
| Darebin | T.W. Blake Park #3 | Murray Rd & Gower St, Preston | Victorian Nepelese CA |
| Darebin | W. Ruthven VC Reserve | Albert Street, Preston | Northern Socials / Northern Socials Women's |
| Melbourne | Poplar Oval | Old Poplar Road, Parkville | Royal Park Reds |
| Merri-Bek | Charles Mutton Reserve | Creedon Street, Fawkner | East Coburg - Haig Fawkner Women's |
| Merri-Bek | Fleming Park | Albert Street, East Brunswick | East Coburg - Haig Fawkner Women's |
| Merri-Bek | Oak Park Reserve | Pascoe Vale Road, Oak Park | Pascoe Vale Central Women's |
| Murrindindi | Kinglake Memorial Oval | Extons Road, Kinglake Central, Kinglake | Kinglake |
| Nillimbuk | Coventry Oval | Elizabeth Street, Diamond Creek | Diamond Creek Women's |
| Nillimbuk | Eltham Central Park | Panther Place, Eltham | Eltham Women's |
| Nillimbuk | North Eltham Reserve | Wattletree Road, Eltham North | North Eltham Wanderers Womens |
| Nillimbuk | Research Park | Englewood Place, Research | Research Eltham College Women's |
| Nillimbuk | Strathewen Reserve | Chadds Creek Road, Strathewen | Strathewen |
| Whittlesea | Ben Frilay Oval | Greysharps Road, Hurstbridge | Hurstbridge Women's |
| Whittlesea | Epping Recreation Reserve | Park Street, Epping | Epping Women's |
| Whittlesea | Kelynack Reserve | Azalea Drive, Mill Park | Rivergum Women's |
| Whittlesea | Laurimar Reserve East | Lakeside Drive, Laurimar | Laurimar Women's |
| Whittlesea | Mill Park Lakes Reserve | The Lakes Boulevard, South Morang | South Morang Women's |
| Yarra | Fairfield Park | Yarra Bend Road, Fairfield | Fairfield / Fairfield Women's |

APPENDIX B: CREASE MARKINGS (including Wide Ball Markings)

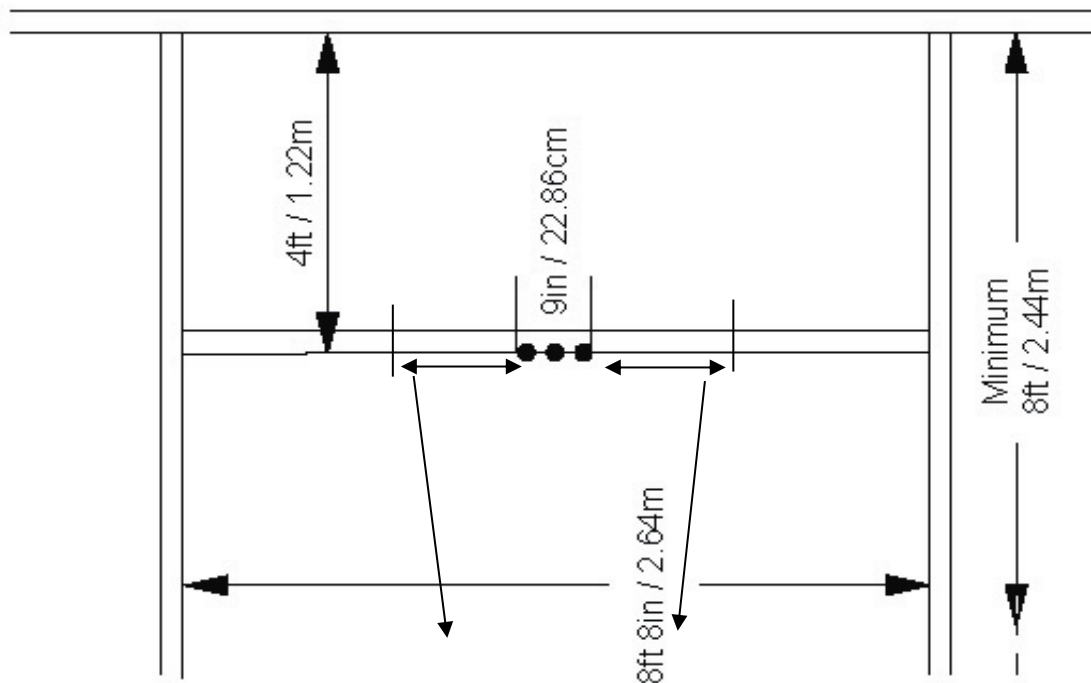

18 in / 45.72cm
Wide Ball Guidelines - From Outside Edge Of Stump To Inside Edge Of Line

APPENDIX C: STUMP DIMENSIONS)

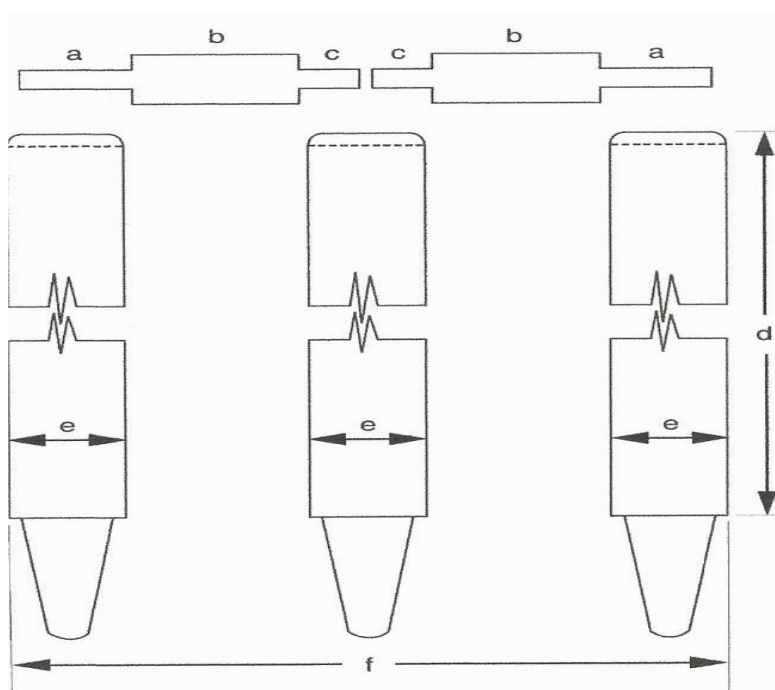

- Bails:- For Senior Cricket – Overall 4.31 Inches/10.95 cm:
 (a) 1.38 in/3.5 cm;
 (b) 2.13 in/5.4 cm;
 (c) 0.81 in/ 2.06 cm
- Stumps:- For Senior Cricket –
 (d) Height 28 in/71.1 cm;
 (e) Diameter: Maximum 1.5 in/3.81 cm; Minimum 1.38 in/3.5 cm
- Overall:- For Senior Cricket –
 (f) Width 9in/2.86 cm